

INSTALLATION INSTRUCTIONS

PARKER SLIDE SHOWER 1F AP

CHROME - PUNP1FS.CP

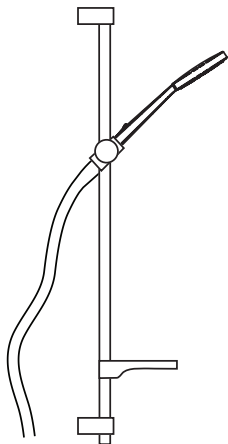

Congratulations on your purchase of this high quality product.

Please read the following before installation and retain (along with your receipt) for future reference.

TECHNICAL SPECIFICATIONS

Suitable for All Pressures

Minimum Pressure = 35kPa

Maximum operating Pressure = 500kPa* (As per NZ Building Code AS/NZ 3500.1)

Maximum operating Temperature = 65 deg. Celsius

For domestic use only.

CONFIGURATION

Mains Pressure systems

Prior to installation, install the flow regulator as shown.

Unequal Low systems

Install as supplied.

Equal Low systems

Install as supplied.

INSTALLATION

*For pressures exceeding 500kPa install a pressure reducing valve. Thoroughly flush all pipes to eliminate any remaining dirt and residue, and install inline filters. Failure to do so may void the warranty. To be installed as per the requirements with AS/NZ 3500.

CAUTION: If using your own screws to install the wall brackets, **DO NOT** use counter sunk type screws as this will void the warranty.

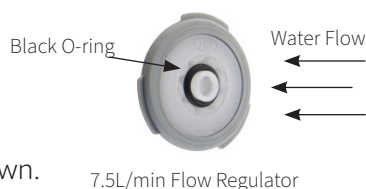

7.5L/min Flow Regulator

Mains Pressure installation only:

Insert the flow regulator with the O ring facing away from the hose (as shown). This will comply with the WELS rating.

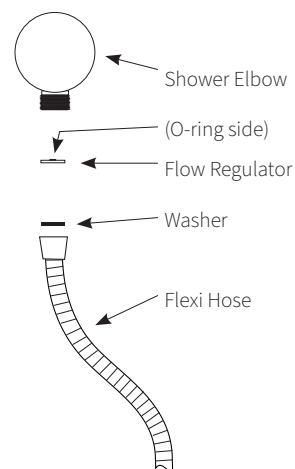

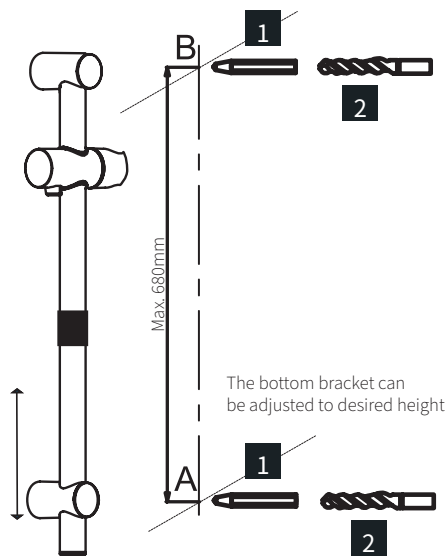

1. Measure and mark anchor positions with pencil.
2. Drill mounting holes suitable for wall anchors.
3. Remove end covers from brackets. Slide bottom bracket off rail, then unscrew retaining screw from top bracket and remove.

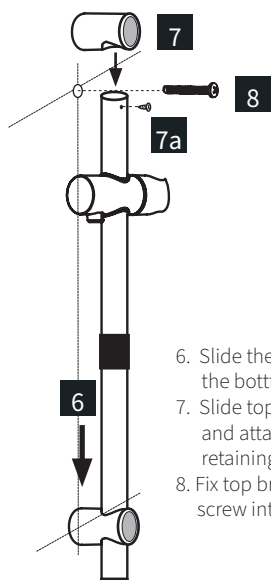

6. Slide the rail tube through the bottom bracket.
7. Slide top bracket onto tube and attach with retaining screw (7a).
8. Fix top bracket in place with screw into wall anchor B.

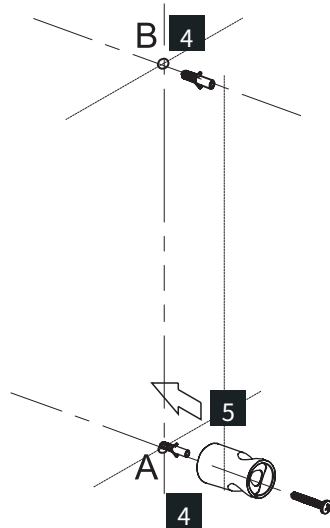

4. Push wall anchors into holes.
5. Fix bottom bracket in place with screw into wall anchor A. Do not overtighten screw.

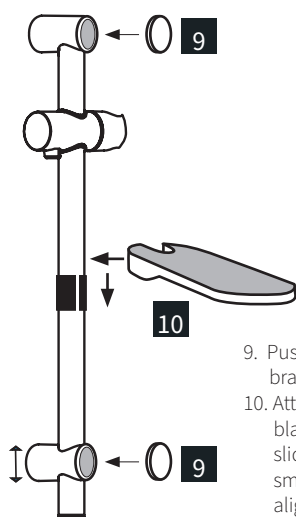

9. Push end covers onto brackets.
10. Attach soap dish to black plastic fitting on slide rail tube, ensure small tab on soap dish aligns with opening on the fitting.

ATTACH PROOF OF PURCHASE HERE

*****IMPORTANT:** Please ensure the thread protruding out of the wall for the shower supply elbow is no more than 7.5mm in length.

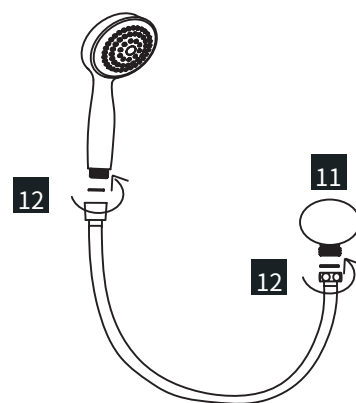

11. Attach the supply elbow to the supply connection on the wall ***
12. Attach hose to elbow and handpiece, then insert handpiece into holder.

WARRANTY

Please call us before removing or undertaking any repair work.

Warranties apply to residential domestic use only. Warranty is void if product is not installed according to our specifications.

In the unlikely event that this product fails during its warranty period, phone 0800 508 009, visit www.harrisonbloy.co.nz, email info@harrisonbloy.co.nz or reach out to your local Harrison Bloy immediately as unauthorised removal of the product may void the warranty.

CARE AND MAINTENANCE

Should not be cleaned with acidic, caustic/alkaline, abrasive, or citric cleaners.

A soft, damp cloth is recommended for cleaning (Not a Micro fibre cloth). Mild soap solutions can also be used on occasion.